

Instructions for Kit No BK102 - 1/24 Greenhouse

This is a kit for a typical 8ft x 6ft greenhouse with a brick base.

Contents of the kit:

Ref	Description	Qty
1	floor assembly	1
2	side assemblies	2
3	rear wall assembly	1
4	front wall assembly (door opening)	1
5	roof assembly (mitred to fit together)	2
6	opening window assemblies	4
7	door/frame assembly	1
8	decorative ridge	1
9	roof trusses	2
10	square strip for corners	4
11	strips for sills	5
12	staging	2
13	staging support strips	6
14	glazing for side walls/roof	4
15	glazing for rear wall	1
16	glazing for front wall	1
17	glazing for door	1



To complete the kit you will need glue, paint and a door handle or knob. You will also need DAS or similar air drying clay and suitable Impress Moulds for the brickwork and floor.

We recommend the use of Aliphatic Resin and a pin point applicator for assembly of the main parts of this kit and Glue'n'Glaze to fix the glazing.

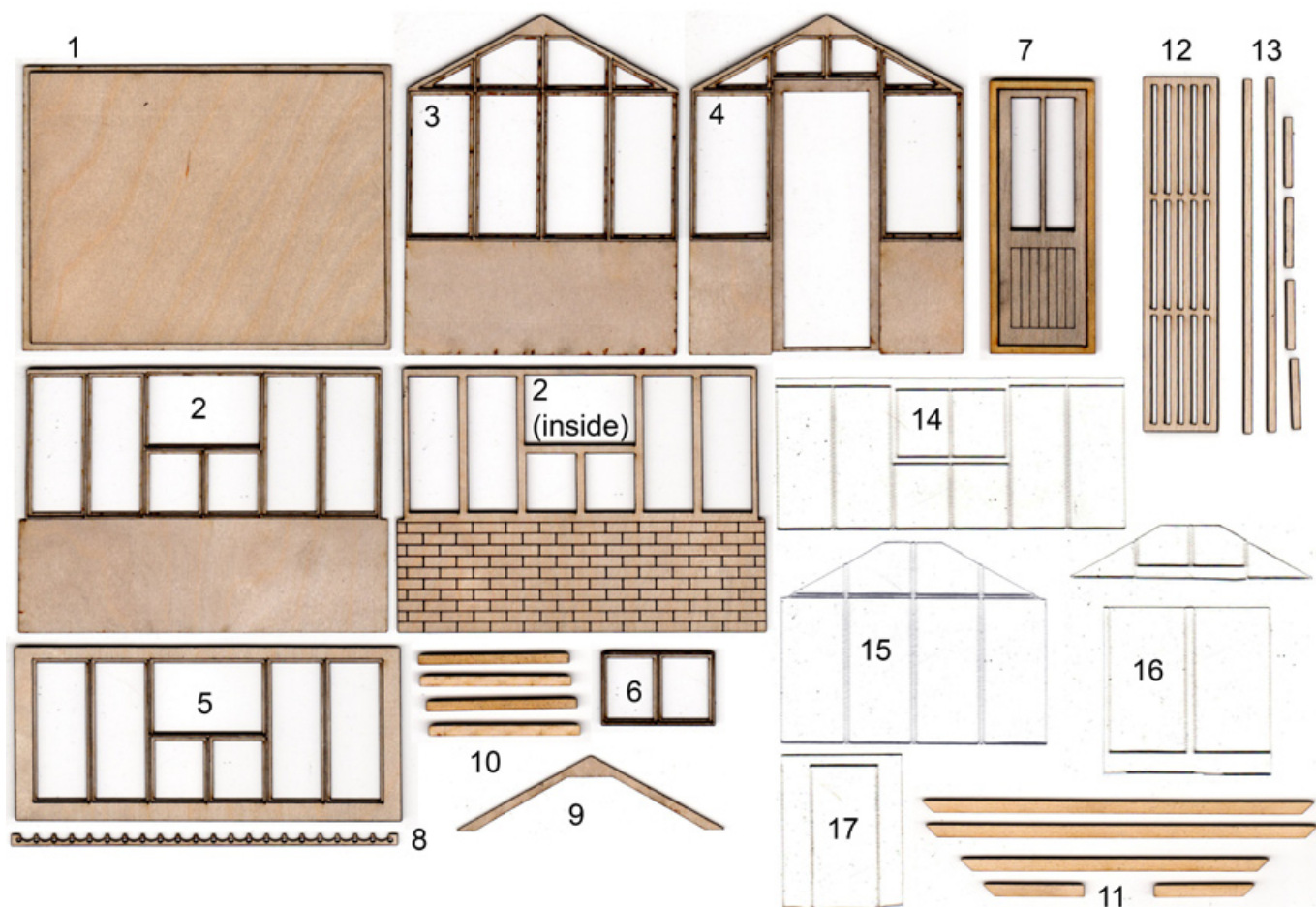

Assembly

The side, rear and front walls, roof sections and opening windows have been supplied part assembled because of the fragility of the overlays. Note that the engraved brickwork is on the inside to represent brickwork that would usually be whitewashed. The door assembly is designed to open outwards and can be fitted for left or right opening. The opening windows can be fixed in either the open or closed positions. Two optional lengths of staging are provided for either side of the greenhouse. Omit one or both of these if you want to have tomato or similar tall plants in the greenhouse.

1. If you are going to fit the staging, start by fixing the staging support strips to the side and end walls. Use the brick courses as a guide to alignment. Aligning the bottom of the strips to the bottom of the top course of bricks gives a suitable height for the staging.
2. Paint all the main components of the kit - walls (2, 3, 4), roof (5), opening windows (6), door/frame (7), roof trusses (9) and the staging (12). It is best to remove the paint from the edges of components where they will be glued together. This can be done by scraping or sanding when the paint has dried. The paint may make the parts warp but this should be corrected if both sides are painted.
3. Apply an appropriate finish to the floor. Typically this would have been a brick, tile or paving path down the centre with soil or gravel on either side. These can be represented using DAS or similar air drying clay and the Impress Moulds we supply, using acrylic paints to colour the surface when the clay has dried.
4. Fit the glazing into the walls, roof and opening windows. The glazing is partially cut and the pieces can be separated either by flexing the sheet or using a sharp knife. Glue'n'Glaze is recommended for fixing the glazing as it dries clear. A spot of glue in each corner (with another spot half way down the sides of the longer panes) should be sufficient to secure the glazing material. Make sure the glazing is pressed firmly into the frames. A cocktail stick or similar can be used to remove any surplus glue.
5. Glue the square corner posts to the side of the front and rear walls aligning the bottom of the post with the bottom of the window frame and keeping the post flush with the inside of the wall. When the glue is dry sand the top of the post to match the profile of the top of the walls. The posts could be painted at this stage or later when the building is assembled.
6. Slide the glazing into the door and glue the door/frame assembly into the aperture in the front wall (for either left or right opening as required).
7. Glue the rear wall onto the step in the floor assembly.
8. Glue a side wall onto the step and to the rear wall. Note that the lower part of the wall fits onto the edge of the rear wall and the upper (window frame) fits onto the square corner post.
9. Glue the other side wall and front wall in place.
10. If required glue the staging onto the staging support strips.
11. Glue the sill pieces immediately below the window frames on each of the walls - some sanding may be required to get a good fit.
12. Glue the two roof sections together (note the opening windows are to the top), glue the roof trusses in place on the inside edge of the outer frame (so that they fit between the end walls). You may find it easier to use superglue to fix the roof together as it sets much quicker.
13. Sand the top edge of the roof to create a narrow flat section and glue the decorative ridge in place.
14. Paint the sills, corner posts and decorative ridge.
15. The roof can be fixed or left loose to allow access to the inside of the greenhouse.
16. Cover the lower part of the walls with DAS and use a stretcher bond impress mould to create the brickwork and paint with acrylic paint, as described in the instructions supplied with the mould.
17. Finally, glue the opening windows to the top edge of the apertures with the windows in the open or closed position, as required.